

**Product Code:**

PCT450-FE45/ZM

**Product Range:**Cable Tray, Zinc Magnesium,  
Light Duty Accessories**Issue Date:**

16/9/2025

**Description:**

450mm 45° Flat Bend for Light Duty ZM Cable Tray

**Features:**

- 10mm Straight Edge.
- Light Duty cable tray accessories available up to 450mm wide.
- Cable tray available in 3 types to suit individual applications.
- Distinctive hole pattern designed to provide maximum flexibility for the installer without compromising strength.
- All light duty tray has a notched end eliminating the need for a separate coupler.
- Manufactured from Zinc Magnesium steel to BS EN 10346:2015.
- Special sizes and bespoke designs are available upon request.
- Lid for cable tray available upon request.
- Solid (plain) cable tray available upon request.
- Can be powder coated to customer specific RAL colour.

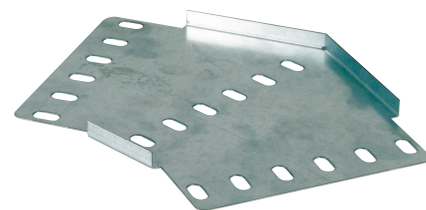
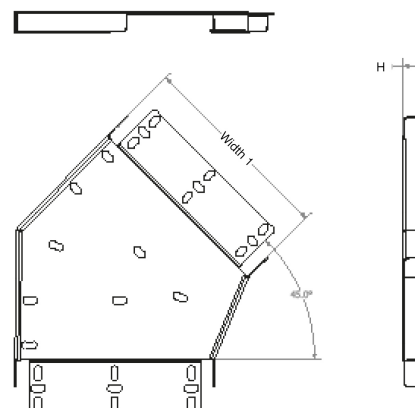

Image for illustrative purposes only

**Technical:****Product Type** Flat Bend**Width** 450mm**Height** 10mm**Weight** 1.87 Kgs**Angle** 45°**Gauge** Light Duty**Material** Zinc Magnesium Steel ZM310**Colour/Finish** Self Colour**Standards** BS EN 61537:2007; BS EN 10346:2015**Pack Quantity** 1

The approximate weights given are for pre-galvanised finish only, in kilograms (nominal) and subject to material thickness tolerance.

**Dimensions: (mm)****H** 10mm**Additional Width 1** 450mm

Tamlex | Harcourt | Halesfield 15 | Telford | Shropshire | TF7 4ER

**T:** 01952 586689 **E:** sales@tamlex.co.uk **W:** www.tamlex.co.uk