



Product Code:	Product Range:	Issue Date:
TC103-15	Strut Channel & Support, Strut Accessories	29/5/2025

Description:

150mm 2 Hole Plain Cantilever Arm

Features:

- 150mm Long 2 Hole Plain Cantilever Arm.
- For use with Tamlex strut framework system.
- Made from 6mm thick steel.
- All dimensions subject to commercial tolerance.

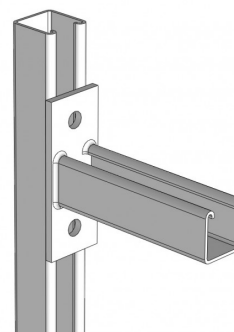

Technical:

Product Type Cantilever Arm

Width 40mm

Height 40mm

Length 150mm

Gauge 2.5mm

Material Post Hot-Dipped Galvanised (HDG)

Colour/Finish Post Hot-Dipped Galvanised (HDG)

Standards BS EN ISO 1461:2009; BS 6946

The approximate weights given are for pre-galvanised finish only, in kilograms (nominal) and subject to material thickness tolerance.