

**Product Code:**

TC103-15

**Product Range:**Strut Channel & Support, Strut  
Accessories**Issue Date:**

19/6/2025

**Description:**

150mm 2 Hole Plain Cantilever Arm

**Features:**

- 150mm Long 2 Hole Plain Cantilever Arm.
- For use with Tamlex strut framework system.
- Made from 6mm thick steel.
- All dimensions subject to commercial tolerance.

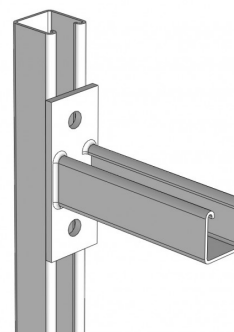
**Technical:****Product Type** Cantilever Arm**Width** 40mm**Height** 40mm**Length** 150mm**Weight** 0.74 Kgs**Gauge** 2.5mm**Material** Post Hot-Dipped Galvanised (HDG)**Colour/Finish** Self Colour**Standards** BS 6946:1988

The approximate weights given are for pre-galvanised finish only, in kilograms (nominal) and subject to material thickness tolerance.